

PowerLux® iHiBay™ Induction Luminaire

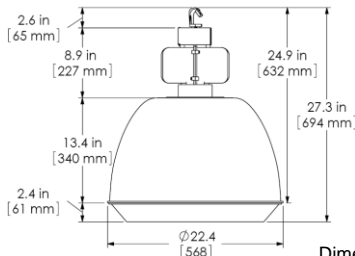

55W QL Induction 100-120V, 200-277V
85W QL Induction 100-120V, 200-277V
165W QL Induction 100-120V, 200-277V

FIXTURE DIMENSIONS



Dimension differs according to type of parts selected

PHOTOMETRICS

IES files available upon request

PACKING DATA

(Housing) 10"x10"x20" Weight: 12 lbs.
(22" Attachments) 24"x24"x24" Weight: 15 lbs.

ORDERING INFORMATION

Model No.	Wattage	Lamp Kelvin (S/P Ratio)	Voltage	Reflector (RR)	Reflector (RL)	Lens
PHB	55	830 (1.35)	100-120V	Micro Cellular (WH)	Aluminum (AL)	Glass (GL)
	85	840 (1.62)	200-277V	Acrylic Clear (CL)	Aluminum White (ALWH)	Acrylic Conical (CO)
	165	850 (1.96)		Polycarbonate (P)	Aluminum Hammer Tone (ALHT)	Acrylic Drop (DL)

Part Number Example: PHB165/850/277/22/RRWH/CO

Description: PowerLux iHiBay Induction Luminaire 165W 5000K 200-277V 22" Micro Cellular Refractor Clear Conical Lens with Clamp Band

Catalog#		Type
Project		
Note		Date
Prepared by		

PROVEN QL INDUCTION LIGHTING TECHNOLOGY WORLDWIDE SINCE 1992

APPLICATIONS

- For warehouse, sports court, aircraft hanger and manufacturing plant

SPECIFICATION FEATURES

- 100,000 hours rated lamp life
- Instant ON and instant re-strike with back-to-full brightness feature
- CRI >80 White light no color shift
- Thermally engineered for sustainable operation designed according to local temperatures
- Die-cast aluminum housing with powder coated white paint finish
- Wide range of accessories available
- Select from Polycarbonate Refractor, Acrylic Clear Refractor or Micro Cellular Foamed Refractor OR
- Select from Aluminum Reflector with Hammer Tone finish or White Powder Coated Aluminum Reflector designed for maximum photometric efficiency and optimum light distribution
- Select from glass flat lens, acrylic conical or drop lens
- Clamp band for assembling lens to the reflector
- 2-level dimming generator up to 50% power reducer to save energy during inactive times. Works with 0-10V control and sensor system. (Special order only)
- Programmable Motion & Daylight Sensor with manual override (Special order only) (Size of sensor varies)
- UL listed for damp locations
- Perfect replacement for HPS and MH HID light sources
- Overall weight is reduced for easy installation and maintenance
- Manufactured in the U.S.A.

ACCESSORIES AVAILABLE

- 18" cord with NEMA twist-lock L5-15, 15 Amp, 277V connector
- Safety cable 3' steel cable with clear vinyl coating, eye and loop ends

22" Attachments



Acrylic Refractor & Conical Lens



Micro Cellular Formed Refractor



Aluminum with Hammer Tone Finish



Powder Coated Aluminum

PowerLux® Corporation

US Manufacturer of Sustainable Energy Efficient Lighting Products
Induction Lighting Proven Success Since 1999

1260 Liberty Way, Suite E Vista, CA 92081 Phone: 760-727-2360 Fax: 760-434-4766

Website: www.powerlux.com E-mail: klpowerlux@gmail.com

121206

Patents pending

Specifications subject to change without prior notice
© 2010 by PowerLux® Corporation. All rights reserved